

NAEV202



20 x 2/1 GN - 40 x 1/1 GN

Item

20 - 18 x 26" / 40 - 12 x 20"



LCD 10" Touch Screen

One Touch

Automatically and with only a single touch, you can access the ideal and most efficient cooking for each dish, due to the exclusive present and widely tested methods, times and system. A wide range of cooking methods is already tested in the field by a highly qualified group of workers.



MULTILEVEL



JUST IN TIME



AUTOCLIMA



FAST-DRY



SMOKING



FLAVOURING



ECOVAPOR



TURBOVAPOR



VIDEO RECIPES



ECOSPEED



GFT
(only for gas models)



LM CLEANING SYSTEM
COMBI CLEAN
CALFREE (*)



CLOUD EVOLUTION



CHEF PORTAL



SYNCHRONISATION



REMOTE SERVICE

(*) only for models with boiler

COOKING MODES

- ICS (Interactive Cooking System), an automatic cooking system for Italian, French, International, Spanish, Russian, Asian and German recipes including their history, ingredients, procedure, automatic cooking program and plate presentation
- Manual cooking with three cooking modes: Convection from 30°C to 300°C (86°F to 572°F), Steam from 30°C to 130°C (86°F to 266°F), Combination Convection + Steam from 30°C to 300°C (86°F to 572°F).
- Programmable modes - Possibility to program and save cooking methods in an automatic sequence (up to 15 cycles) giving each program its own name, picture and information on the recipe

OPERATION

- DISPLAY that can be configured based on the needs of the user, bringing forward the programs used most
- LAINOX Cloud Wi-Fi/Ethernet connection system for saving personal settings, software updates, HACCP data archiving and downloading new recipes
- Automatic "one touch" cooking (ICS)
- Organization of recipes in folders with preview, giving each folder its own name
- Intelligent recognition of recipes in multilevel folders
- 10" colour screen (LCD - TFT) that is high definition and capacitive with "Touch Screen" functions
- SCROLLER PLUS knob with Scroll and Push function for confirming choices
- Instantaneous display in ICS cooking of the HACCP graphic

CLEANING AND MAINTENANCE

- Self-diagnosis before starting to use the equipment, with descriptive and audible signalling of any anomalies
- LM automatic cleaning system with separate container of COMBICLEAN liquid detergent
- Manual cleaning system with retractable hand shower

CONTROL EQUIPMENT

- Autoreverse (automatic reverse of fan rotation) for perfect cooking uniformity
- Automatic parallel compartment and core temperature control, DELTA T system
- Automatically regulated steam condensation
- Programmable deferred cooking
- Ability to choose up to 6 fan speeds; the first 3 speeds automatically activate the reduction in heating power
- For special cooking methods, you can use an intermittent speed
- Temperature control at the product core using probe with 4 detection points
- 2 core probe, a LAINOX exclusive
- Core probe connection through a connector outside of the cooking chamber, with the ability to quickly connect the needle probe for vacuum cooking and small pieces
- USB connection to download HACCP data, update software and load/unload cooking programs
- Ready for SN energy optimization system (optional)
- SERVICE program for: Inspecting the operation of the electronic board and display of the temperature probes - Appliance operation timer for all primary functions for programmed maintenance
- ECOSPEED - Based on the quantity and type of product, Naboo optimizes and controls the delivery of energy, maintains the correct cooking temperature, preventing any fluctuations (-10% energy / -30% water / -5% weight loss *)
- ECOVAPOR - With ECOVAPOR system there is a definite reduction in water and energy consumption due to the automatic controls of the steam saturation in the cooking chamber (-10% energy / -30% water / -10% steam *)

CONSTRUCTION

- IPX5 protection against sprays of water
- Perfectly smooth, watertight chamber
- Door with double tempered glass with air chamber and interior heat-reflecting glass for less heat radiation towards the operator and greater efficiency
- Internal glass that folds to open for easy cleaning
- Door with 3 locking points
- Adjustable hinge for optimal seal
- Deflector that can be opened for easy fan compartment cleaning

ELECTRIC HEATING SYSTEM

- Cooking compartment heating elements of armoured INCOLOY 800 type

SAFETY FEATURES

- Cooking compartment safety thermostat
- Cooking compartment safety device for pressure built-up and depression
- Fan motor thermic protection
- Magnetic door switch
- Lack of water displayed alarm
- Self-diagnosis and fault display
- Component cooling system with overheat display control

STANDARD EQUIPMENT

- Automatic washing system LM - equipped with 1 cleanser tank COMBICLEAN - 10 l. (2.64 gal)
- Wi-Fi connection
- Multipoint core probe - Ø 3 mm (Ø 0.12")
- Built-in and retractable hand shower with tap
- Trolley
- 2 stainless steel grids 2/1 GN (18x26")

OPTIONAL - TO BE REQUESTED WHEN ORDERING OVEN

- Extra charge for energy saving system connection
- SMOKEGRILL - 3 in 1 - Barbecue System / Smoking / Flavouring
- Extra charge for Ethernet connection

ACCESSORIES

- Multipoint core probe for large items. Pin length 180 mm. (7.08"). - Ø 3 mm (Ø 0.12")
- Needle core probe - Ø 1 mm. (Ø 0.04")
- Multiprobes system - 2 multipoint core probes - Ø 3 mm. (Ø 0.12")
- Fat filter
- USB pen to download HACCP data, update software and load/unload cooking programs
- Flanged feet kit for marine installations
- Trolley with drip tray
- Plated meals trolley with drip tray
- Trolley thermal cover

NAEV202

TECHNICAL DATA

Chamber capacity	GN <i>No. - Inch.</i>	20 x 2/1 - 40 x 1/1 <i>20-18 x 26 - 40-12 x 20"</i>	Total electric power	kW	61.8
Distance between layers	mm <i>Inch</i>	63 <i>2.48</i>	Gas versions nominal heating output	kW / kcal <i>kW / BTU</i>	- / - <i>- / -</i>
Number of meals		300 / 500	Chamber heating output	kW / kcal <i>kW / BTU</i>	60 / - <i>60 / -</i>
External dimensions	mm <i>Inch</i>	1290 x 895 x 1810 h <i>50.79 x 35.24 x 71.26" h</i>	Steam heating output	kW / kcal <i>kW / BTU</i>	- / - <i>- / -</i>
Dimensions with packing	mm <i>Inch</i>	1410x1120 x 2060 h <i>55.51 x 44.09 x 81.10" h</i>	Fan power	kW	1.8
Weight - Net / Gross	kg <i>Lbs.</i>	345 / 460 <i>760.59 / 1,014.12</i>	Power supply voltage	V - 60 Hz	3ph / 208
			Consumption	Amps	172*

Special voltages and frequencies upon request

* Two power supply cables (two terminal blocks)

The data reported in this document is to be considered non-binding. Lainox ALI S.p.A reserves the right to make changes at any time, without prior notice

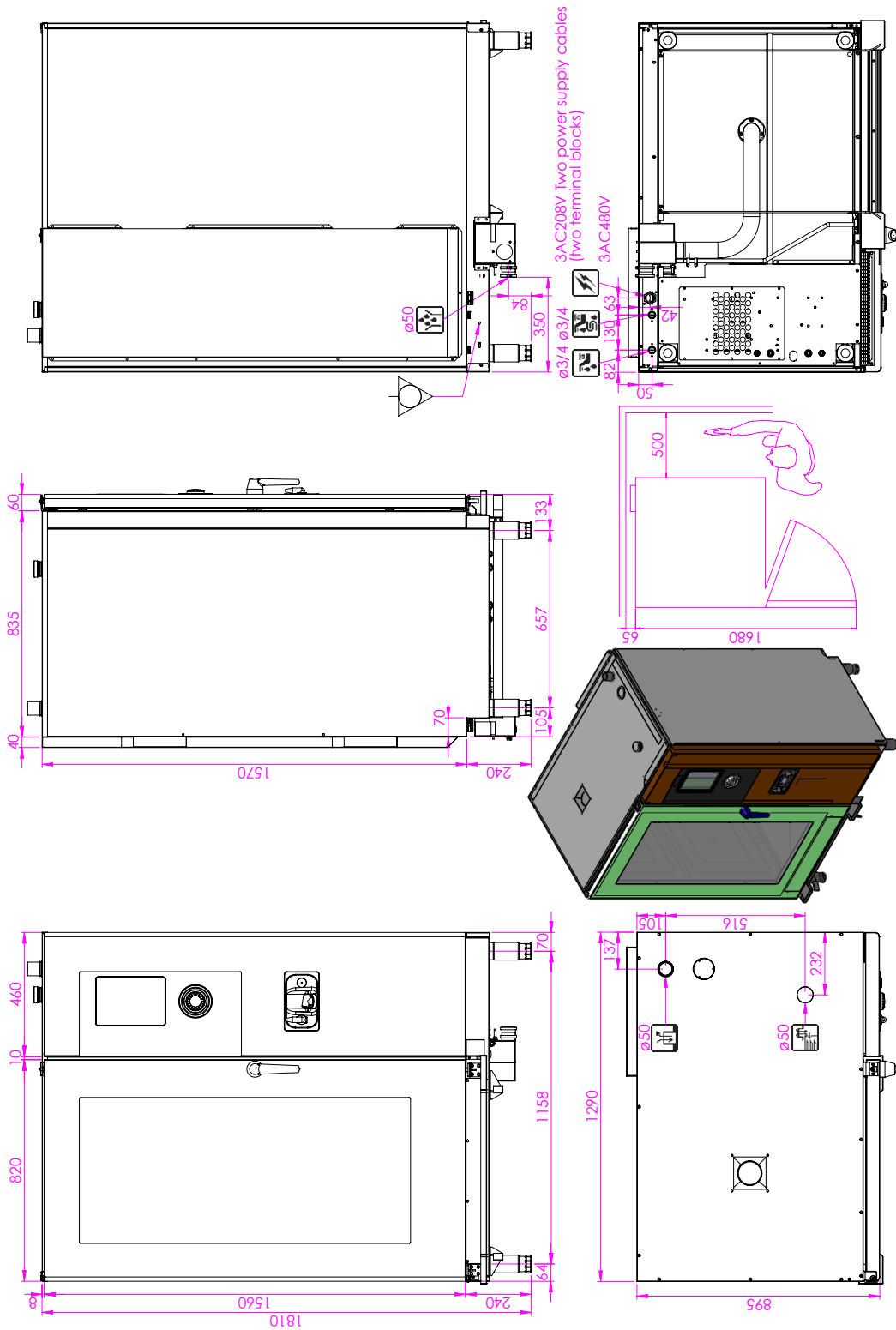

Electric power supply cable inlet



Gas inlet and type of thread



Flue pipe



Boiler descaling cap

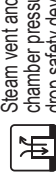

Steam vent and chamber pressure drop safety device



Oven steam vent



Air extraction



Normal water inlet



Softened water inlet



Liquid outlet



Steam trap



According to CE rules, gas ovens must be installed where proper evacuation of burnt gas can be provided (type B13, B23, A3)

The data reported in this document is to be considered non-binding. Lainox ALI S.p.A reserves the right to make changes at any time, without prior notice

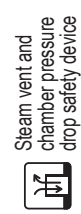
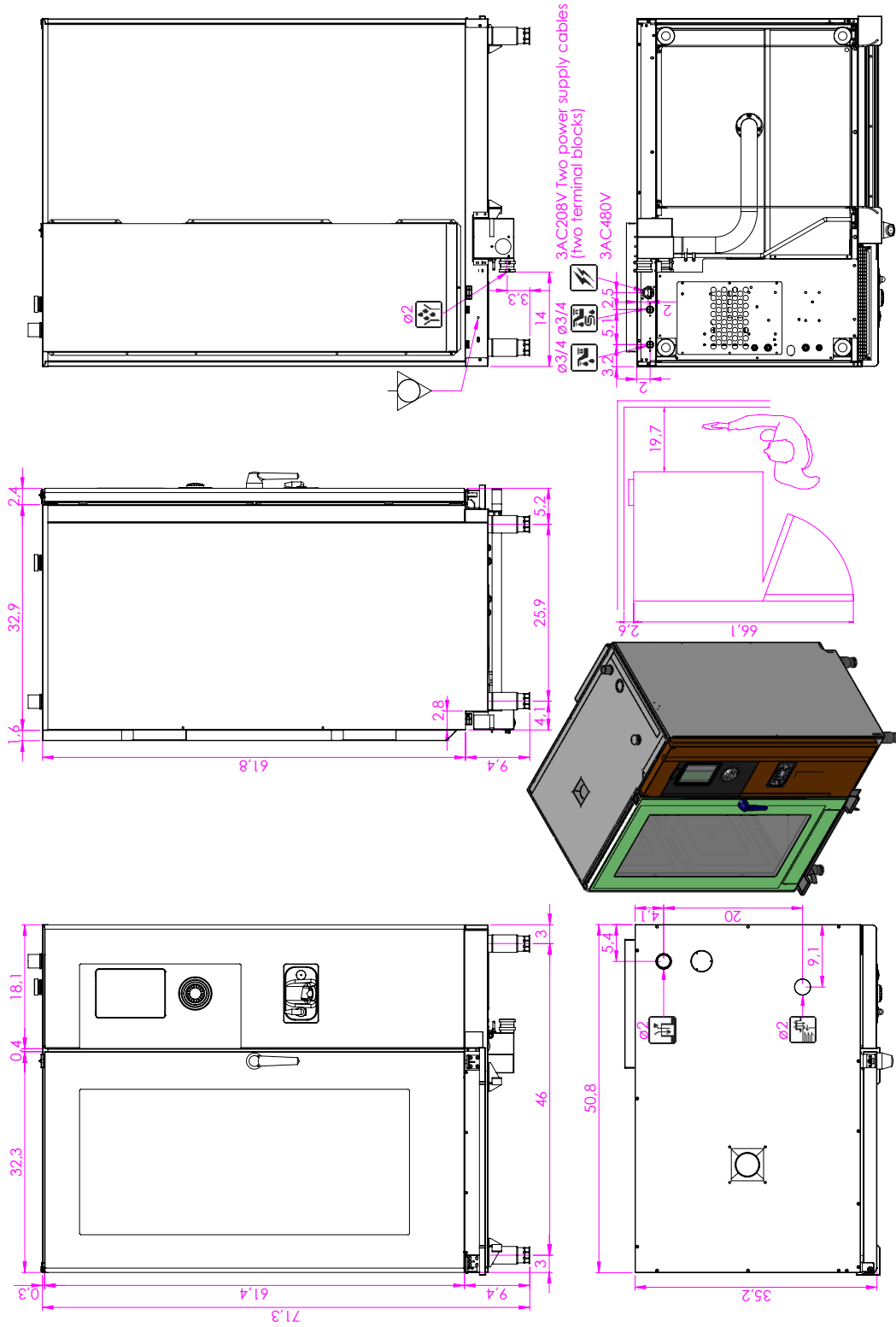

According to CE rules, gas ovens must be installed where proper evacuation of burnt gas can be provided (type B13, B23, A3)